

**ETHIRAJ COLLEGE FOR WOMEN (Autonomous)**  
**Chennai – 600 008**

Affiliated to the University of Madras  
College with Potential for Excellence  
Re-accredited with A Grade by NAAC



**4.1 PHYSICAL FACILITIES**

**4.1.1 INFRASTRUCTURE AND PHYSICAL  
FACILITIES FOR TEACHING-LEARNING**

*(Topographical Survey Map of Ethiraj College)*

**TOPOGRAPHICAL SURVEY AT ETHIRAJ COLLEGE FOR WOMEN  
ETHIRAJ SALAI, EGMORE, CHENNAI.**

NORTH DIRECTION

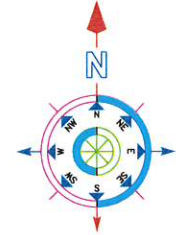

**LEGEND:-**

SYMBOL	DESCRIPTION
▲	BENCH MARK
○	BOUNDARY FINING POINT
✳	COCONUT TREE
✳	NEEM TREE
✳	OTHER TREE
✳	ASHOKA TREE
✳	MANGO TREE
✳	TEAR WOOD TREE
✳	JACK FRUIT TREE
○	LAMP POST
○	MANHOLE
RM	RAIN WATER MANHOLE
T	POWER POST

**AREA DETAILS:-**

DESCRIPTION	AREA IN	
	SQ.M	ACRES
TOTAL AREA OF THE SITE	2267.651	5.598

**NOTES:-**

1. SURVEY DONE DURING JULY-2022
2. ALL DIMENSION ARE IN METER AND FEET
3. SURVEY DONE-BOUNDARY AS IDENTIFIED BY THE CLIENT

**PROJECT TITLE:**

**TOPOGRAPHICAL SURVEY AT  
ETHIRAJ COLLEGE FOR WOMEN  
CHENNAI.**

**CLIENT:**

XXXXXXXXXXXXXXXXXXXX  
XXXXXXXXXXXX  
XXXXXXXXXXXX

**SURVEYED BY:**

**RELIABLE CONSULTANTS**  
G.T.S. LAND MAPPING  
REGD. OFF: PLOT NO.05/A, 5th STREET, LAKSHMI NAGAR,  
MAIPAKKAM, CHENNAI-600 091  
MOBILE: 9840070050, 9840579526.  
EMAIL: asprbopgr@gmail.com  
reliableconsultants@yahoo.co.in  
WEB: www.reliableconsultants.com

DRAWN:	CHECKED:	DATE:	REV:	SCALE:
Balaji R	K.S / ASP	18.07.2022	01	DWG. NO 01

FILE PATH: E:\2022\BALAJI\JULY\ETHIRAJ COLLEGE A2

**LIST OF BUILDING & AREA**

S.NO	BUILDING NAME	SQ.METER	SQ.FEET
1	ADMIN AUDITORIUM	807.487	8691.789
2	SCIENCE BLOCK 1,2,3 & OFFICE	2305.473	24816.111
3	ECONOMIC DEPARTMENT	605.059	6512.856
4	MESS	426.714	4593.155
5	LIBRARY AREA	867.750	9340.455
6	HOSTEL-1	456.096	4929.421
7	HOSTEL-2	691.470	7442.971
8	HOSTEL-3	684.542	7368.416
9	CANTEEN	354.834	3819.438
10	JOB & CONTROLLER OF EXAMINATION	655.020	7093.695
11	VIP LOUNGE	139.719	1503.935
12	SPORTS BUILDING	407.987	4391.549
13	U/C ADMIN BUILDING	886.957	9547.126

*S. Kothai.*

**PRINCIPAL  
ETHIRAJ COLLEGE FOR WOMEN  
(AUTONOMOUS)  
CHENNAI-600 008.**

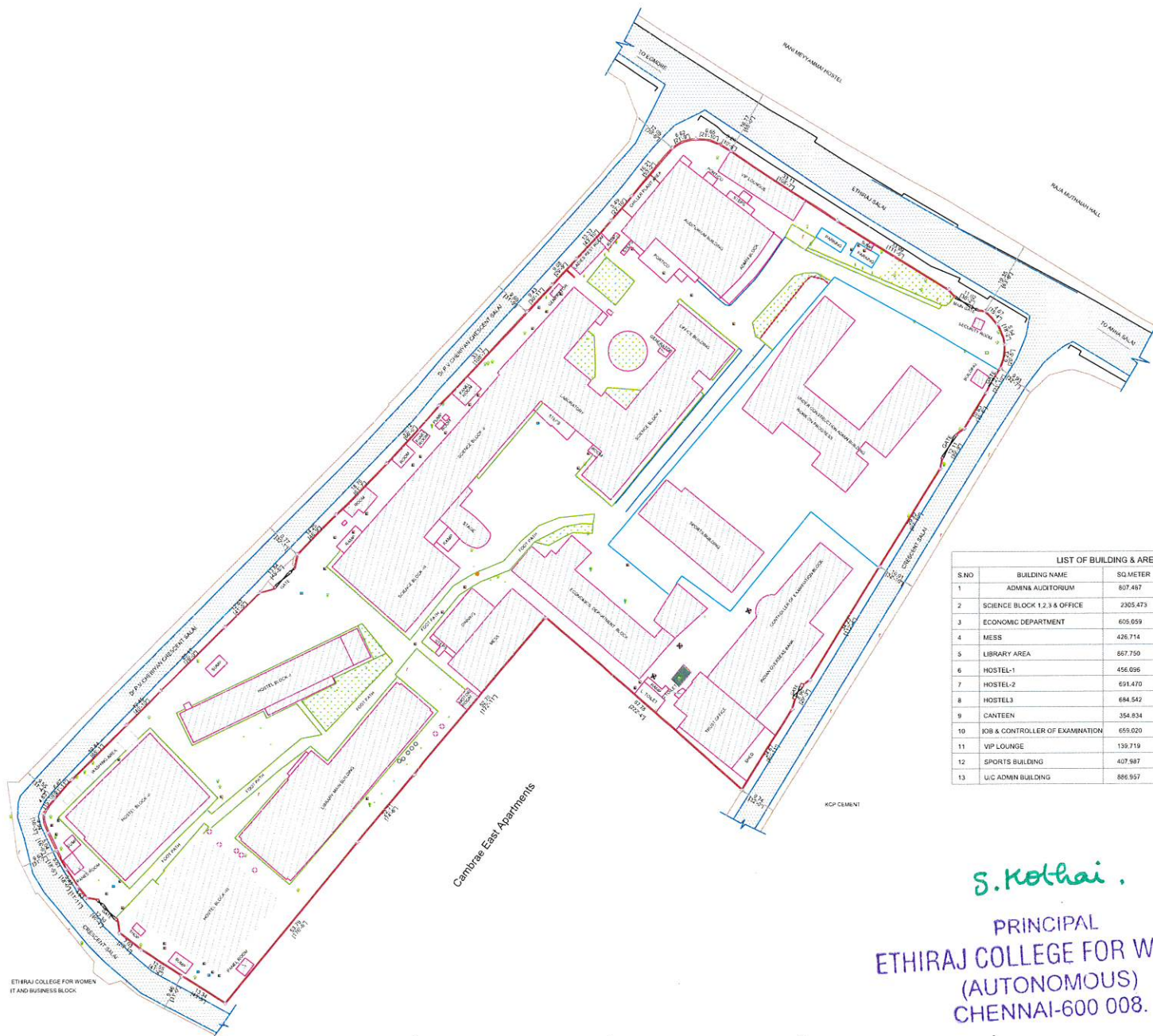



# TOPOGRAPHICAL SURVEY AT ETHIRAJ COLLEGE FOR WOMEN CAMPUS-II, EGMORE, CHENNAI.

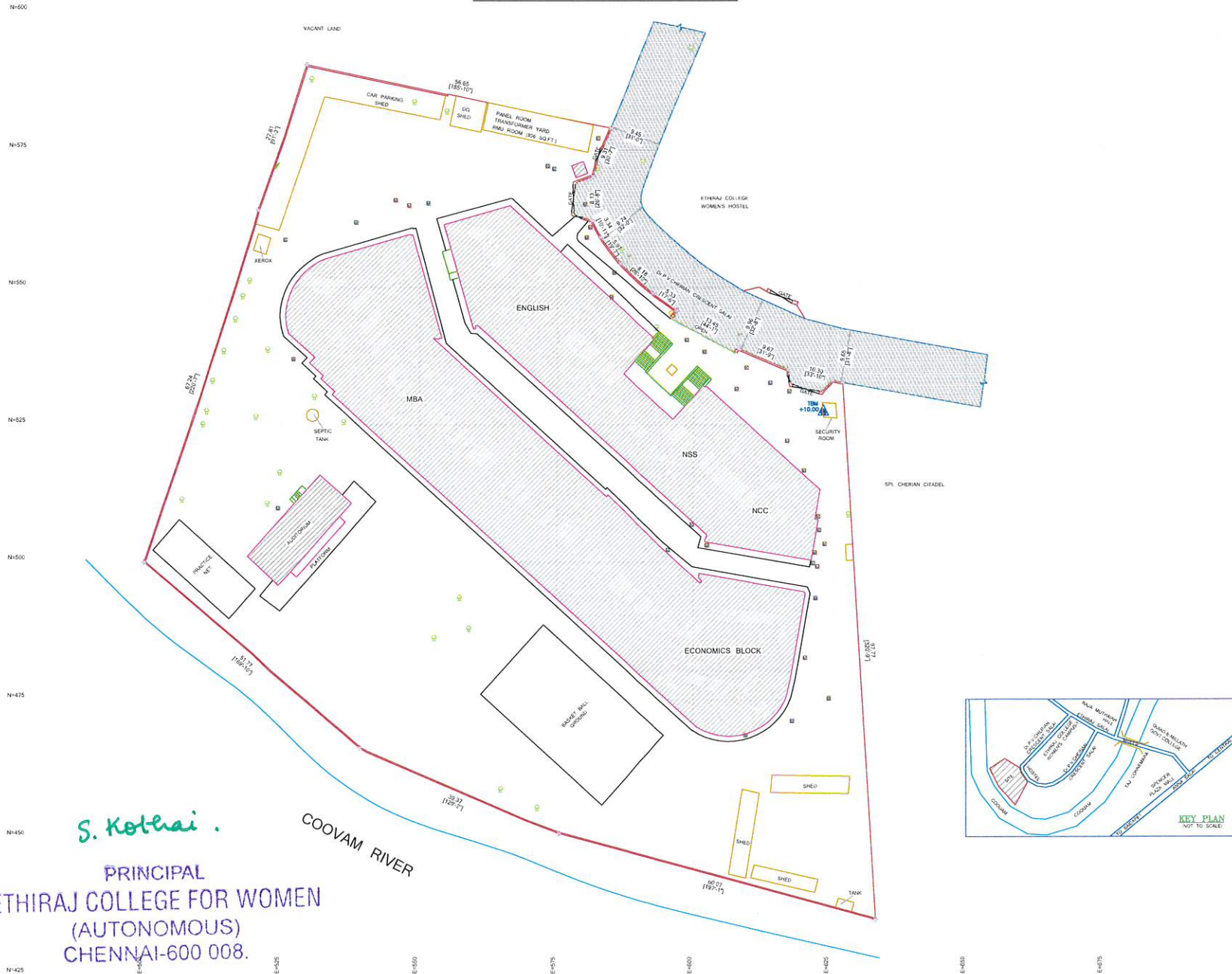

*S. Kothai .*  
**PRINCIPAL**  
**ETHIRAJ COLLEGE FOR WOMEN**  
**(AUTONOMOUS)**  
**CHENNAI-600 008.**

NORTH DIRECTION

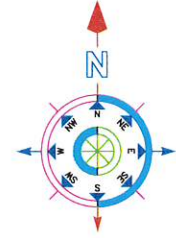

**LEGEND:-**

SYMBOL	DESCRIPTION
	BENCH MARK
	BOUNDARY TURNING POINT
	TREE
	MANHOLE
	LAMP POST
	POW-H POST
	TRANSFORMER

**AREA DETAILS:-**

DESCRIPTION	AREA IN		
	SQ.M	SQ.FT	ACRES
TOTAL AREA OF THE SITE	13115.920	141178.593	3.241

**NOTES:-**

1. SURVEY DONE DURING JAN-2020
2. ALL DIMENSION ARE IN METER AND FEET.
3. BENCH MARK IS BASED ON THE FLOOR LEVEL OF SECURITY SHED AND ITS VALUE IS +10.000
4. SURVEY DONE-BOUNDARY AS IDENTIFIED BY THE CLIENT.

**PROJECT TITLE:**

**TOPOGRAPHICAL SURVEY AT  
ETHIRAJ COLLEGE**

**CLIENT:**

**M/s SAI HARE.**  
CHENNAI.

**SURVEYED BY:**

**RELIABLE CONSULTANTS**  
 GIS, LANDMAPPING  
 REGD.OFF: PLOT NO.105/4, 5th STREET, LAKSHMI NAGAR,  
 MADIPAKAM, CHENNAI-600 051  
 MOBILE: 9840070050, 9840079528  
 EMAIL: asprbopgpr@gmail.com  
 reliableconsultants@yahoo.co.in  
 WEB: www.reliableconsultants.com

DRAWN	CHECKED	DATE	REV	SCALE
S.SRIDHAR	K.Saravanan	14.01.2020 18.07.2022	01	DWG. NG 01

FILE PATH: E:\2022\JULY\BAIA\ETHIRAJ COLLEGE A2